

# Wellborn 2010-2011 Design Contest Entry

Entry ID: 100297

#	Customer	Entry	Designer	Photographer
1	0001002541 SUNSET TILE & BATH INC	100297	Audra Lamb, ASID sunsettile.audra@qwestoffice.net 602-789-8700	Sunset Tile & Bath sunsettile.audra@qwestoffice.net 602-789-8700 Owner: Entrant
Project		Project Details		Project Date
Debbie McNail Master Bath		Bathroom Type: New Construction Size:118 x 116		07/2010
Series	Door Style	Species		Finish
Select	Prairie	Maple		Sienna
Description				
<p>Project: Debbie McNail Master Bath Design Statement:</p> <ul style="list-style-type: none"> <li>• This Master Bath's builder grade configuration limited possibilities of elongated vanity as well as tub area. Reducing the vanity size allowed for enlarging tub platform and installing a tile surround.</li> <li>• The customer wanted to allow for a taller tub splash due to the roman tub faucet being modified into a wall mount diverter and spout. The counter top backsplash was incorporated into the tub splash by continuing the travertine ogee molding and tumbled mesh to create a cohesive look through the bath.</li> <li>• In order to give the customer and more contemporary look, Praire Maple cabinetry with a Sienna finish was used and allowed the bathroom to have balance between the light and dark finishes.</li> <li>• The drawers were upgraded to wood dovetail drawer boxes to give the customer a higher quality finish, but still keeping the cabinet economical.</li> <li>• The shower layout was reconfigured to allow the customer to incorporate and shower bench connecting with the tub platform.</li> <li>• The customers incorporated an adjustable shower arm to allow for customization between their different heights.</li> <li>• We used natural travertine tiles in two colors and multiples sizes to give visual interest without being overwhelming in their space.</li> <li>• We also incorporated a frameless heavy glass shower enclosure with clear glass to allow for easy visibility of the new tile patters as well as increasing the feeling of a larger bathroom.</li> <li>• The large format mirror was also replaced with two custom framed mirrors to give a more inviting look to the vanity area.</li> <li>• A slab travertine counter top with under mount sinks gave a neutral look to the vanity area and made the cabinetry more of a focal point in the room.</li> </ul>				

MASTERBEDROOM

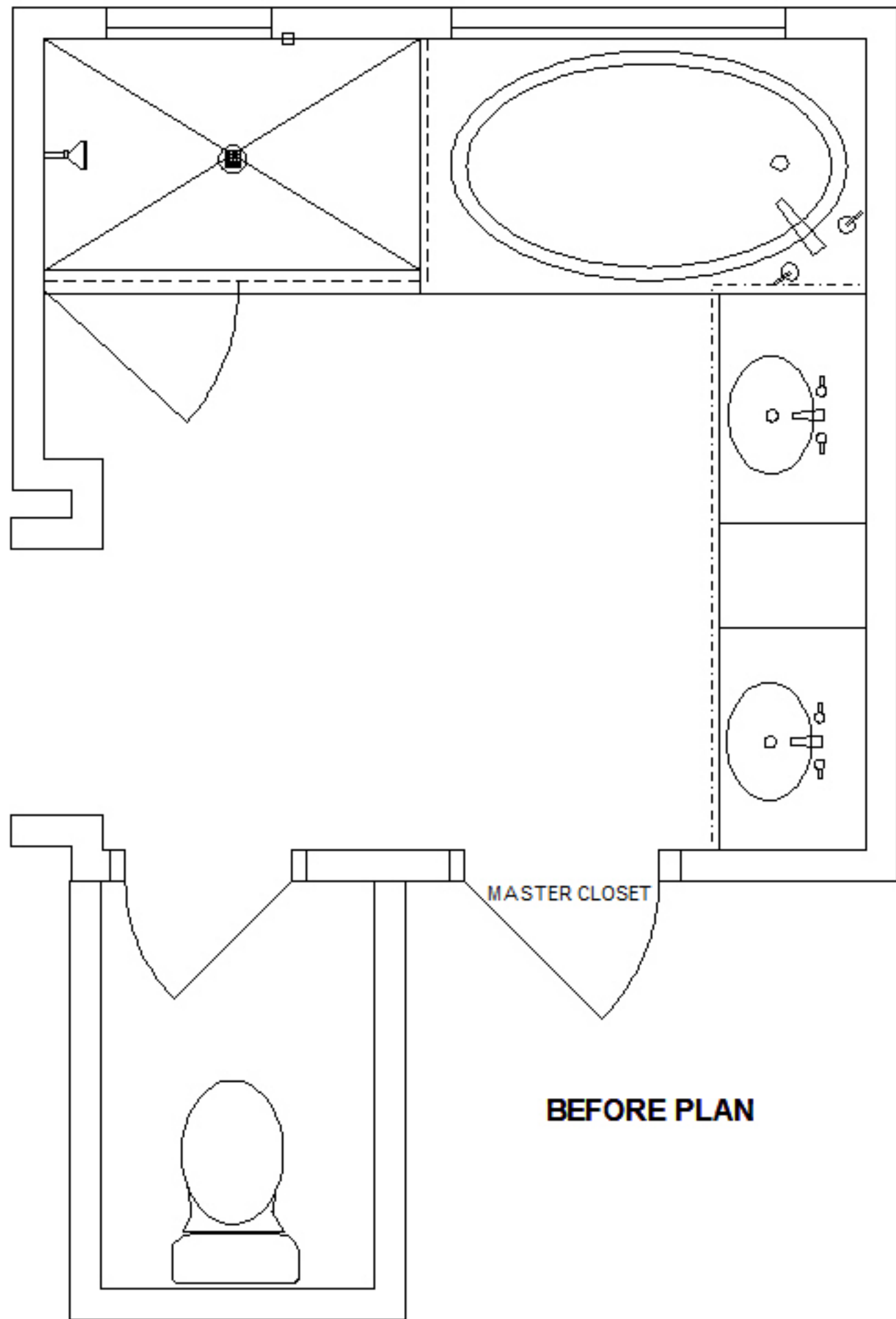

MASTER CLOSET

**BEFORE PLAN**





MASTERBEDROOM

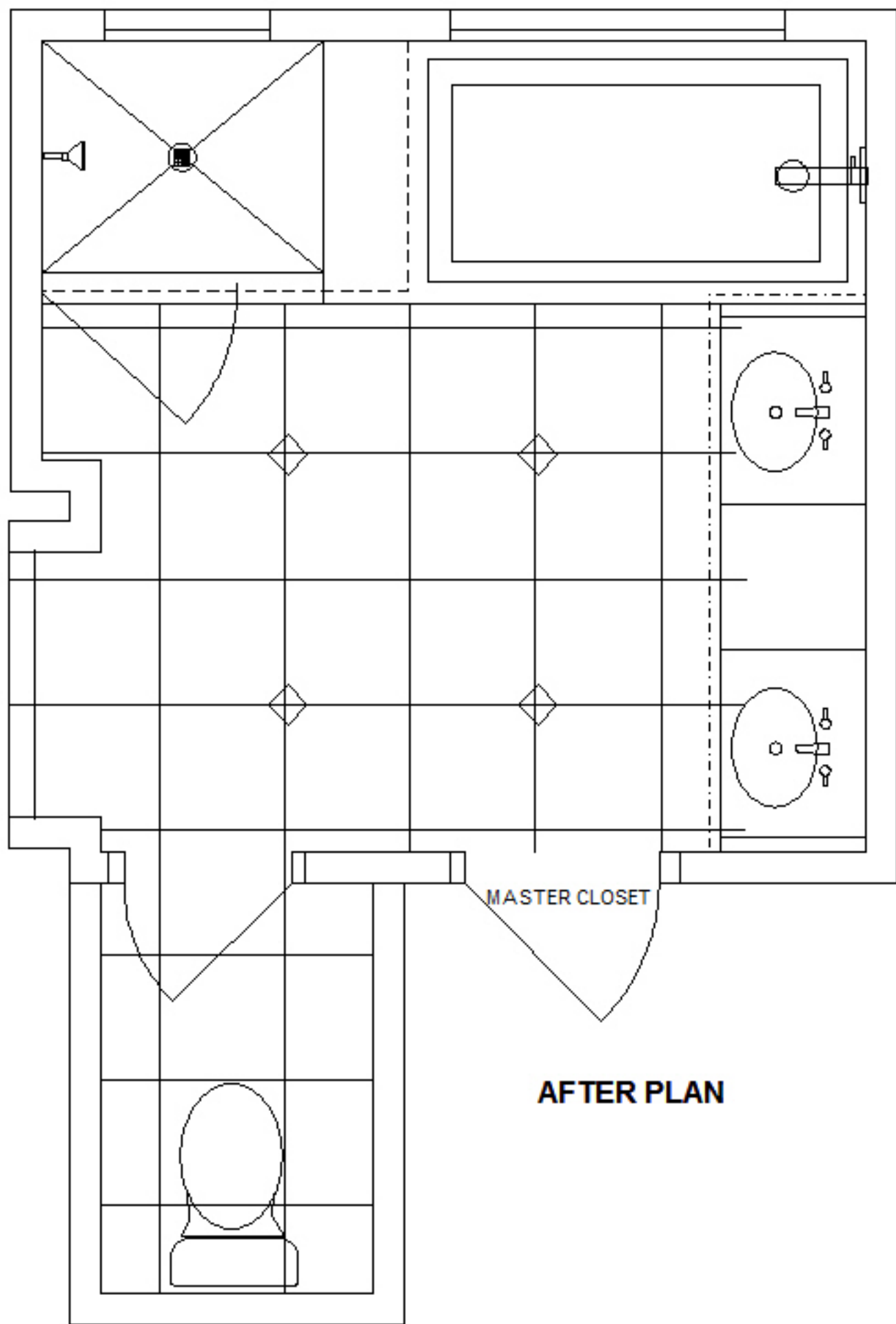

MASTER CLOSET

**AFTER PLAN**





