

Entry			
100230			
Project	Project Details		Project Date
Stressfree wet bar	Other Rooms Type: Remodel Size:60		06/2009
Series	Door Style	Species	Finish
Premier	Vienna	Cherry	Natural Cherry Java
Description			
<p>For this homeowner, it's an answer to the old, "Every time I have a party, everyone ends up in the kitchen, and we don't have enough room to serve." This wet bar remodel sits in a high-visibility area close to the kitchen. This extra countertop gives my client a serving location, ready to serve up snacks and hors d'oeuvres. We removed a small wall dividing the living room from the kitchen, then centered the wet bar to be accessing from anywhere in the room.</p> <p>We have used the Elegant Vienna Cherry in the Natural Java finish. Unique knobs and handles were used to accent the simple modern look of this cabinet. The small layout has everything needed. A small stack of drawers was installed for serving utensils. We utilized Wellborn's custom dishwasher door program. The full height doors were used on the sink cabinet, to coordinate with the dishwasher door. The far right cabinet has the large roll out trays for bigger platters. The wall cabinets gave them the extra storage they needed for glasses. We designed the center of the wet bar using the modern wine rack. All the wall cabinets were ordered with the extended face frame modifier. We then attached the triple bead edge molding above the doors. The decorative crown molding was easily added to the ceiling. The base was trimmed with base molding. This small addition to the clients home, made entertaining fun and stress free.</p> <p>behind those cabinet doors aren't just shot glasses and single malts, but also wine coolers, kegeries, icemakers, dishwashers, plasma televisions, and other accessories that transform an ordinary space into the life of the party.</p> <p>Butler's Pantry Bar</p> <p>Constructed as built-ins or to resemble oversized furniture pieces, these wall-spanning wet bars (sometimes called buffets) transform a transitional space near the kitchen or dining room into an efficient entertaining area. While it's obvious that upper cabinets hold wine glasses and beer steins, guests might not know that icemakers and bottle-cooling drawers are often concealed behind the fine cabinetry. And that's the idea: great-room polish with kitchen function. A long countertop with the sink positioned at one end makes party-food prep more convenient. Handsome stone countertops provide a durable, stain-resistant work surface that's easy to wipe clean. Often, materials are slightly upgraded from what's in the kitchen, since here they're on public view.</p>			

Before:



After:



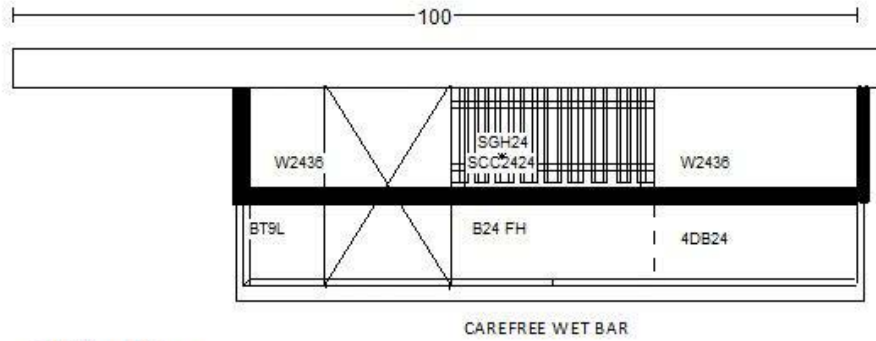

Wellbom Vienna
 Natural Java Finish

Parts List

- 2 BM (BASE MOLDING ON THE BOTTOM)
- 2 LGCM (CROWN MOLDING)
- 2 SBEM (ATTACH TO THE EXTENDED FACE FRAMES)
- 2 CAPM (LIGHT RAIL MOLDING)
- CUSTOM DOOR FOR REFRIGERATOR
- STEMWARE
- HANDLES ON DRAWERS / KNOBS ON DOORS

Wellbom Vienna
Natural Java Finish

